

45 feet, 3 section.  
Center section, 17.5 feet.

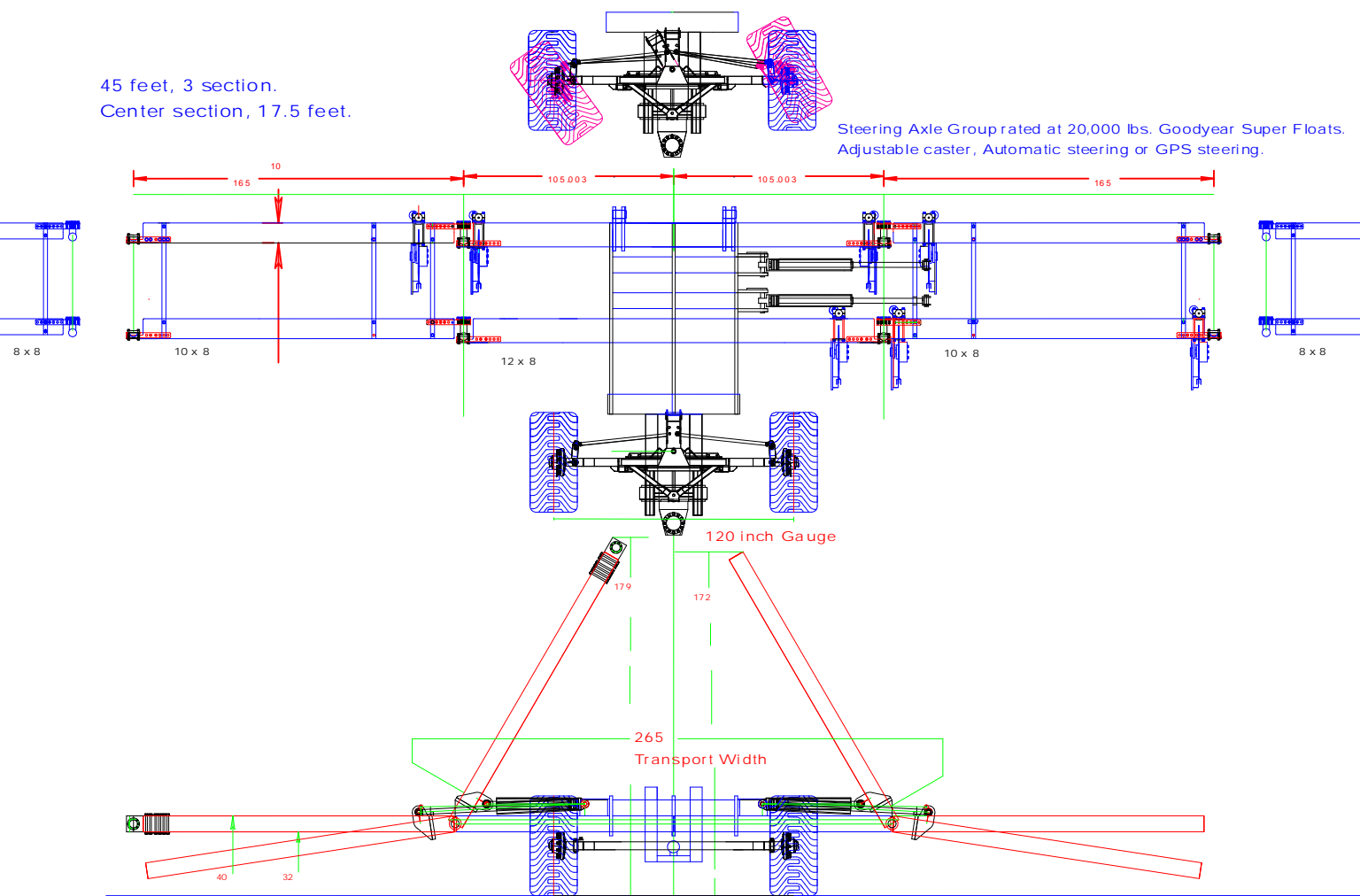

AAA Series. 8 x 12 15 inch band spacing.

GPS and Manual Steering. Rated to 680 horsepower, Ball And Socket Frames.

| Application Width 8 x 12 bar | Center                | Transport Width | Transport Height | Transport Height. Squat | Openers | Opener Type Section, Cylinders, 5 inch    | Without Engines. FOB Spokane. |
|------------------------------|-----------------------|-----------------|------------------|-------------------------|---------|-------------------------------------------|-------------------------------|
| 540 in.<br>45 feet. 2 point  | 7 row<br>17 ft. 6 in. | 22 ft. 3 in.    | 15 ft. 4 in.     | 14 ft. 4 in.            | 36      | P-51C, P-51 CUE<br>3 three section 4 cyl. | \$360,000                     |
| 720 in.<br>60 feet. 2 point  | 7 row<br>17 ft. 6 in. | 22 ft. 3 in.    | 15 ft. 11 in.    | 14 ft. 11 in.           | 48      | P-51C, P-51 CUE<br>5 three section 8 cyl. | \$460,000                     |
| 840 in.<br>70 feet. 2 point  | 7 row<br>17 ft. 6 in. | 22 ft. 3 in.    | 15 ft. 11 in.    | 14 ft. 11 in.           | 56      | P-51C, P-51 CUE<br>5 three section 8 cyl. | \$490,000                     |

Steering Tandems and Track in Custom Application. 15 inch band spacing.

|                       |        |              |              |              |    |                            |           |
|-----------------------|--------|--------------|--------------|--------------|----|----------------------------|-----------|
| 900 in.<br>75 feet.   | 9 row  | 29 ft. 2 in. | 17 ft. 6 in. | 15 ft. 9 in. | 60 | P-51C, P-51 CUE            |           |
| 870 in.<br>72.5 feet. | 8 row  | 26 ft. 8 in. | 17 ft. 6 in. | 15 ft. 9 in. | 58 |                            |           |
| 840 in.<br>70 feet.   | 6 row  | 19 ft. 2 in. | 17 ft. 6 in. | 15 ft. 9 in. | 56 | P-51C, P-51 CUE            |           |
| 870 in.<br>72.5 feet. | 7 row  | 22 ft. 2 in. | 17 ft. 6 in. | 15 ft. 9 in. | 58 | P-51C, P-51 CUE            |           |
| 12 inch band spacing. |        |              |              |              |    |                            |           |
| 840 in.<br>70 feet.   | 6 row  | 19 ft. 2 in. | 17 ft. 6 in. | 15 ft. 9 in. | 70 | P-51C, P-51 CUE            |           |
| 960 in.<br>80 feet    | 10 row | 30 ft. 5 in. | 17 ft. 9 in. | 16 ft. 1 in. | 40 | 24 inch<br>P-51C, P-51 CUE | \$592,127 |
| 1080 in.<br>90 feet   | 10 row | 30 ft. 5 in. | 20 ft. 5 in. | 18 ft. 6 in. | 36 | 30 inch<br>P-51C, P-51 CUE | \$625,423 |

Squat becomes a valuable feature in transport at 90 feet.

Recognized, standard interstate overpass clearance of 14.5 feet.

Long distance transport. Delivery Moves, Front and rear boggies are moved to end low position. Brakes inclusive.

70 feet to 90 feet 5 section.

Seven and six inch hydraulic cylinders welded,  
Hydraulic down pressures has loop feed back.  
Section Control with Positive Downpressure at each wing.

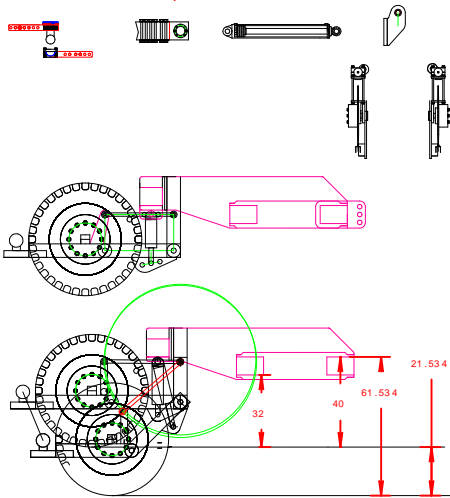

Progressive Deep Banding in No-Till.

